

ROOM CONFIGURATION AND SLEEPING CHARTS



Please see below for individual accommodation hut details and location within the Kerem Adventure Camp site. To assist you with organising the sleeping arrangements for your camps within the huts you have been allocated we have also included sleeping chart templates for each hut!

HUT DETAILS

HUT	MAX PERSONS	BED STYLE
Hut 1	20-21	1 x Queen Bed, 9 x Bunk Beds
Hut 2a	26	13 x Bunk Bed
Hut 2b	19	9 x Bunk Beds, 1 x Single Bed
Hut 3	40	19 x Bunk Beds, 2 x Single Beds
Hut 4	16	16 x Single Beds
Hut 5	20	4 x Bunk Beds, 12 Single Beds
The Lodge	3-6	3 x Double Beds, 3 x ensuites

SITE MAP

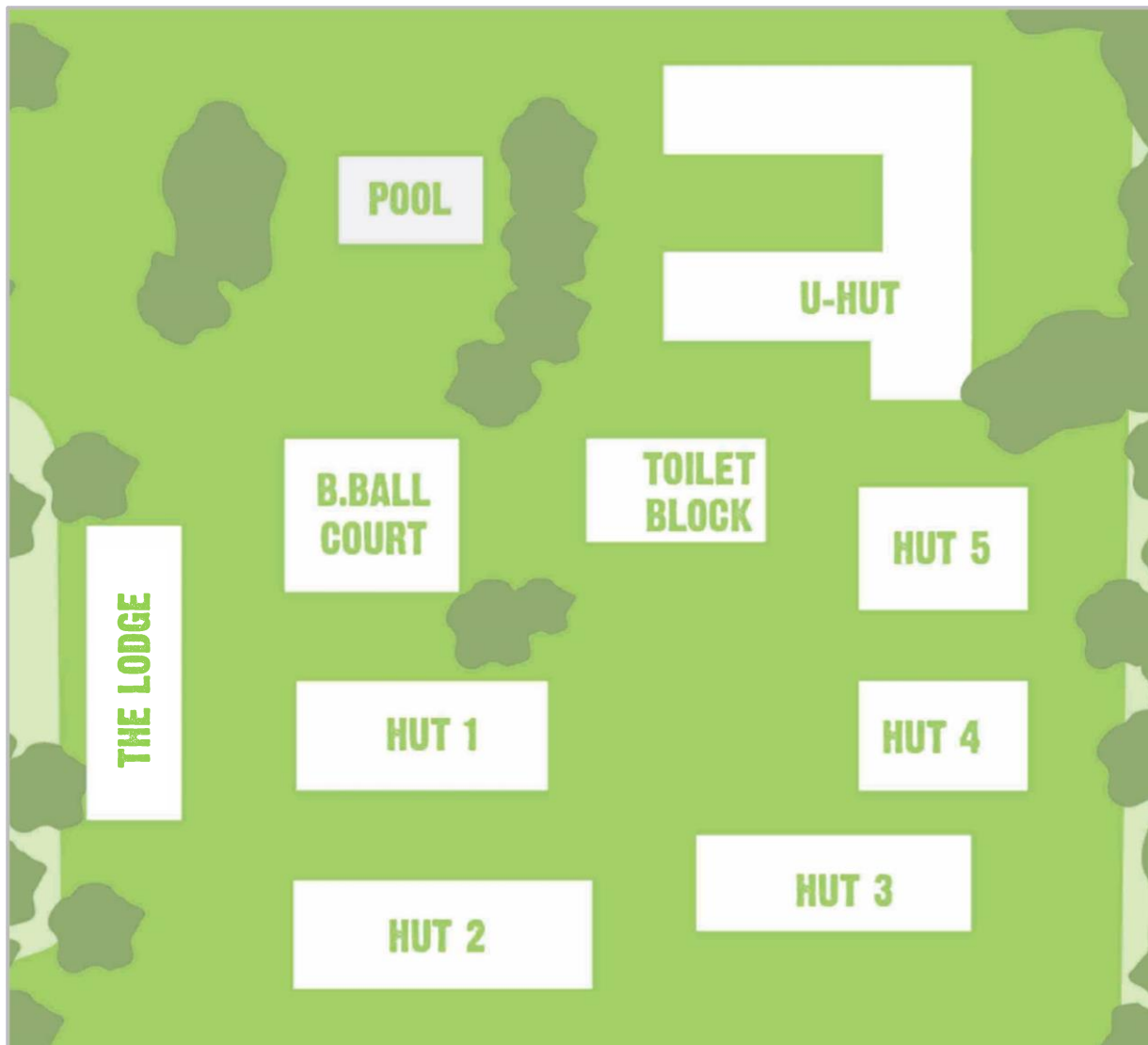

HUT 1 - SLEEPING CHART



Hut 1 has an open sitting room and sleeps up to 21-22 campers and includes:

- 1 room with a queen bed
- 9 rooms with 1 x bunk bed

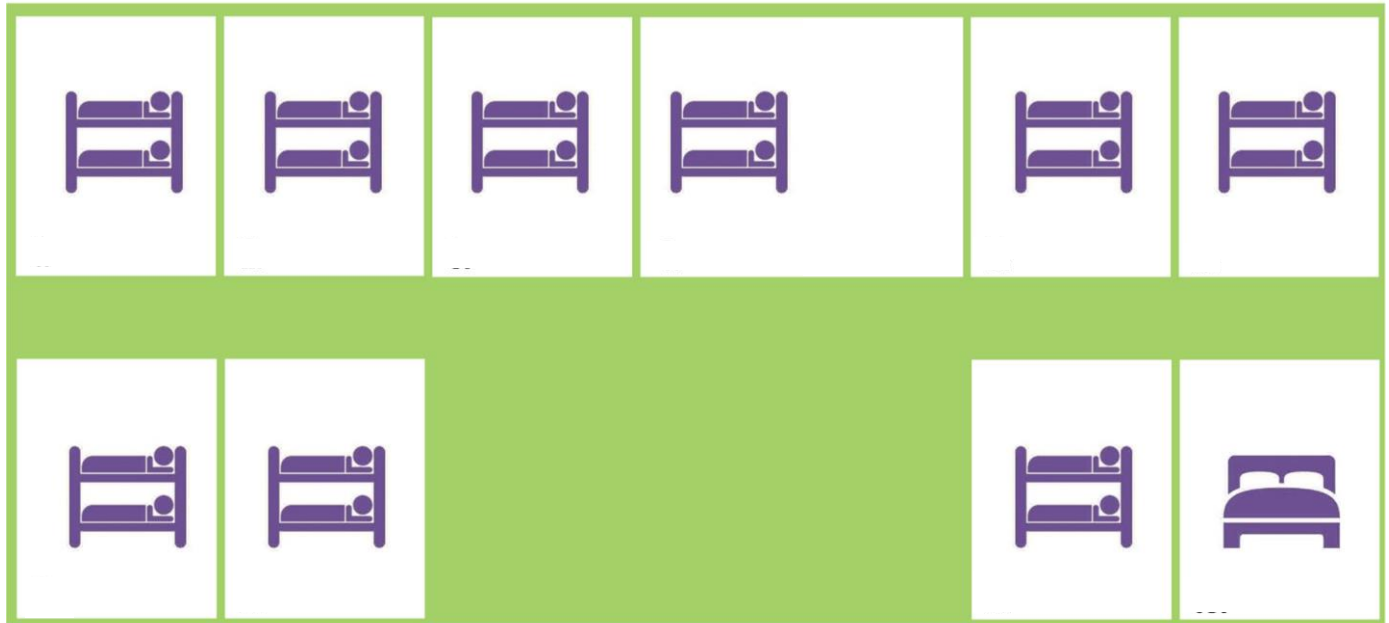

HUT 2 - SLEEPING CHART

Hut 2 can be divided into 2 sections 2A and 2B sleeping up to 47 campers. Hut 2B cannot be used in isolation from Hut 2A

HUT 2A:

- 1 room with a 8 bunk beds
- 1 room with 2 x bunk beds
- 1 room with 3 x bunk beds
- 1 room with 1 x bunk bed

HUT 2B:

- 2 rooms with 3 bunk beds
- 1 room with 2 x bunk beds
- 1 room with 1 x bunk bed
- 1 room with 1 single bed

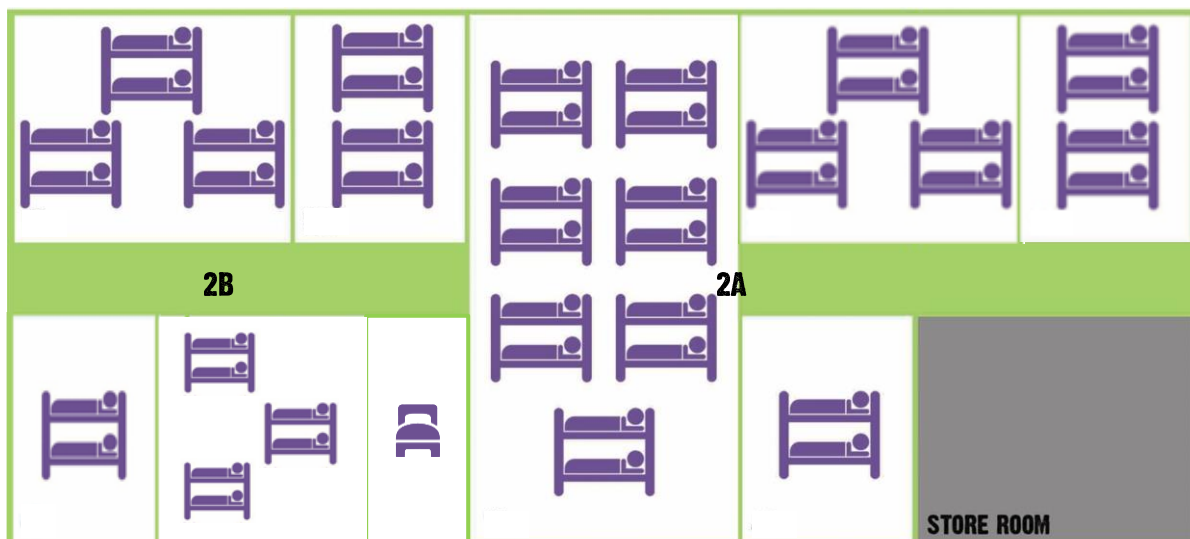

HUT 3 - SLEEPING CHART



Hut 3 includes a sitting room and sleeps up to 34-35 campers in the following rooms:

- 2 rooms with 3 x bunk beds
- 1 room with 1 double bed
- A large open room with 11 x bunk beds

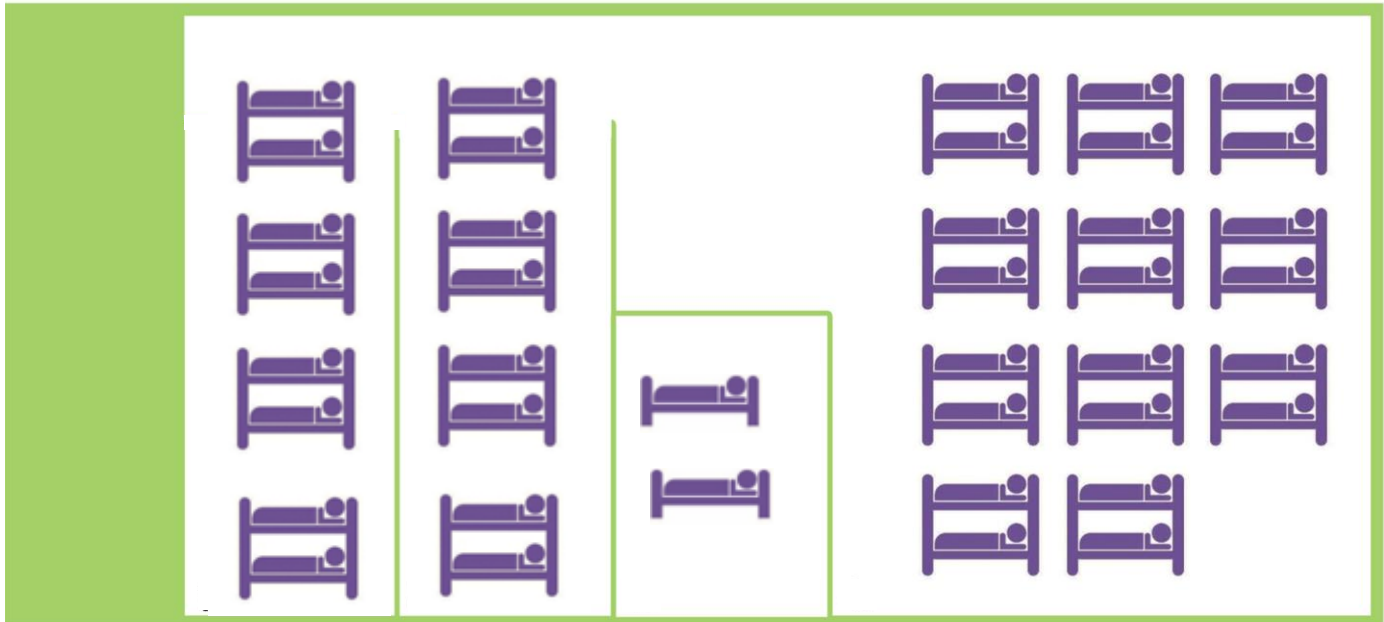

HUT 4 - SLEEPING CHART

Hut 4 sleeps up to 16 campers in 8 rooms each containing 2 single beds.

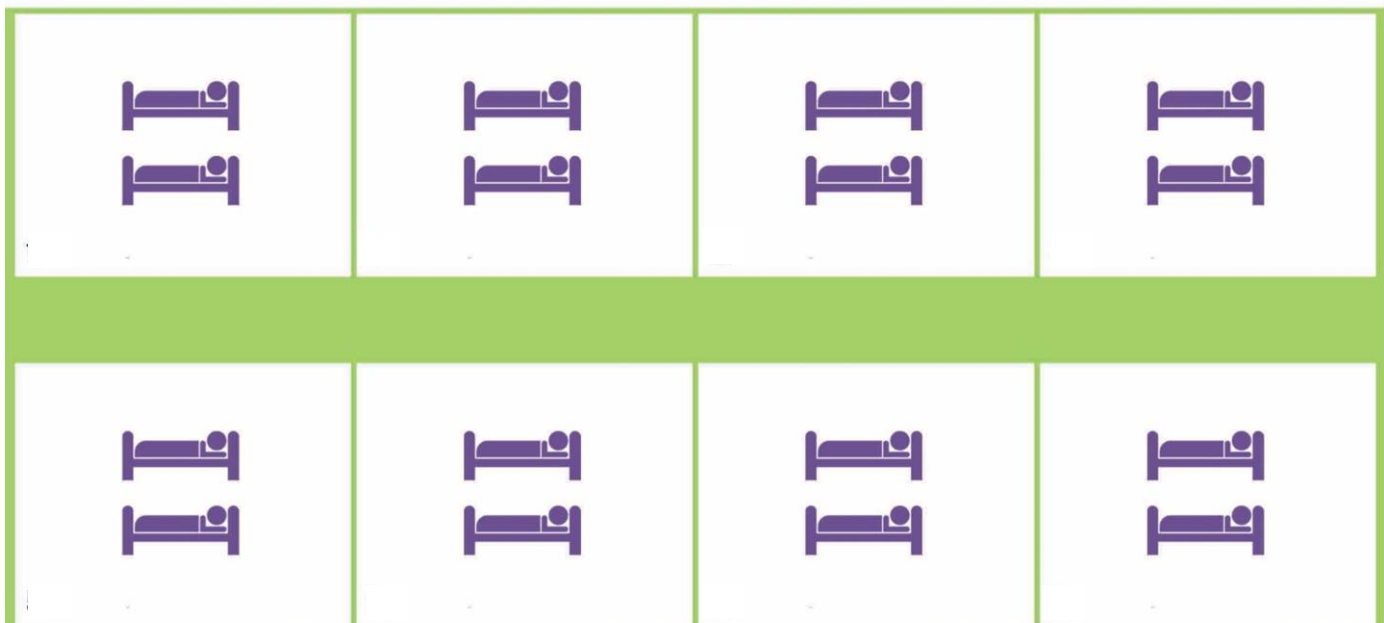

HUT 5 - SLEEPING CHART



Hut 5 sleeps up to 20 campers and includes:

- 2 rooms with 2 x bund beds, 2 single beds
- 4 rooms with 2 x single beds

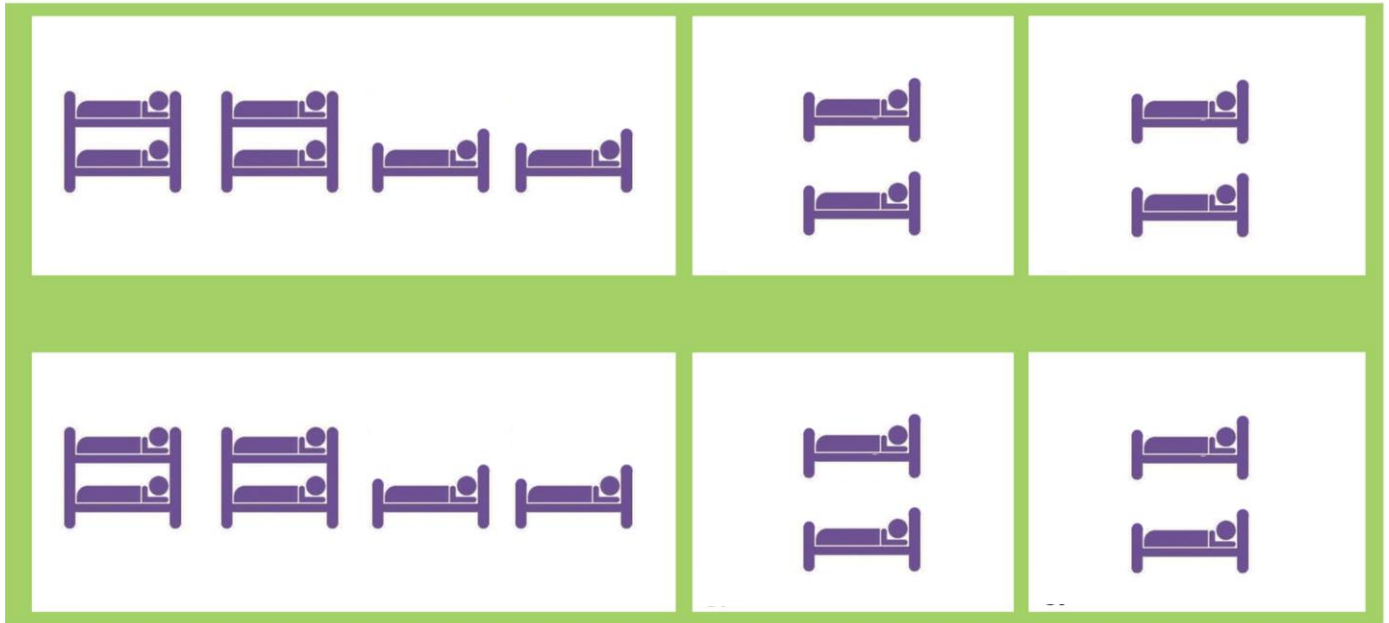

THE LODGE - SLEEPING CHART

The Lodge sleeps up to 6 campers and includes:

- 3 rooms with 1 x double beds – rooms 1, 2 and 3
- Each room features a private ensuite, reverse-cycle air conditioning and a TV

Please note: The Lodge must be pre-booked, additional charges apply

